



Cedar Rapids Convention Complex

350 1st Avenue NE—Cedar Rapids, IA 52401

(319) 731-4444

PARKING DIRECTIONS

Self-Parking: Guests may self-park in either the Convention Center Parking Garage on 1st Avenue, across from the Hotel or in the Five Seasons Parkade Garage, located next to the hotel at the corner of 1st Avenue and 5th Street. Both Garages attach to the Doubletree by Hilton Cedar Rapids Convention Complex by skywalk on the third level of the garages. The skywalk enters the hotel on the second floor, near the U.S. Cellular Arena. Guests should take the elevator at the end of the Skywalks to the lobby of the hotel and proceed into their event.

Self-Parking Charges: \$.75 per hour (first hour free) with a daily maximum of \$12. *Guests pull a parking ticket when they arrive at the garage. Upon departure, guests insert this ticket back into the auto-attendant parking machine and the charge is calculated. Guests may pay the parking charge with cash or credit card.**

Valet-Parking: Guests may valet park their cars from the front drive of the hotel, on 1st Avenue. When assisting guests with their parking, our Valet team will also direct them to their destination inside the hotel.

Valet-Parking Charges: \$15 for events, \$22 for overnight.

*On occasion, usually during large events/arena events, the Parking Garage will charge a flat fee upon arrival. This is call "Event Parking" and is done to make it easier for guests to arrive/depart in an efficient manner. This is done at the parking facility's discretion.



DOUBLETREE
BY HILTON™
CEDAR RAPIDS
CONVENTION COMPLEX

DoubleTree by Hilton Cedar Rapids Convention Complex

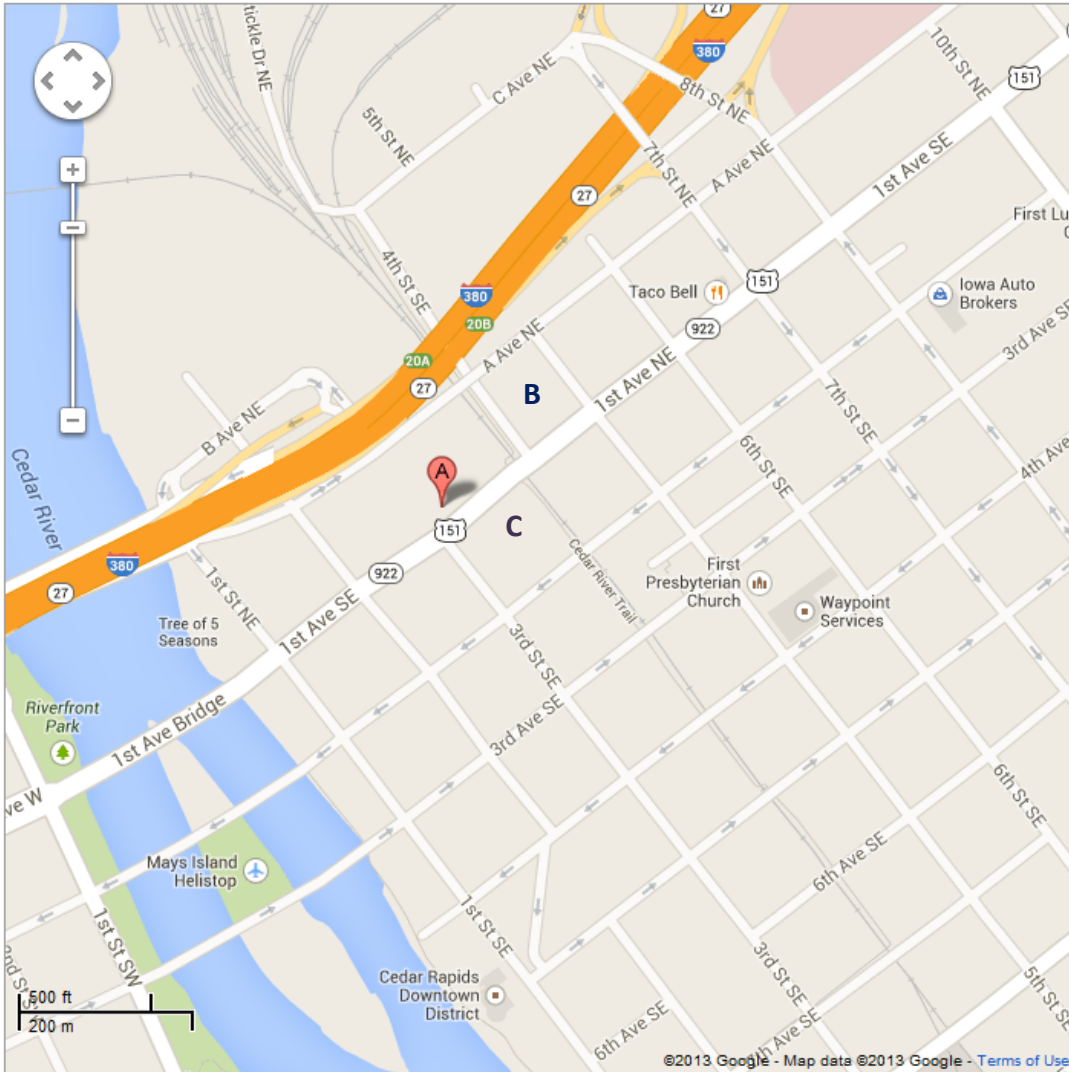

PARKING RAMP LOCATIONS

A—Hotel Location: 350 1st Avenue

B—Five Seasons Parkade: 400 1st Avenue

C—Convention Center Ramp: 325 1st Avenue



DOUBLETREE
BY HILTON™
CEDAR RAPIDS
CONVENTION COMPLEX

DoubleTree by Hilton Cedar Rapids Convention Complex

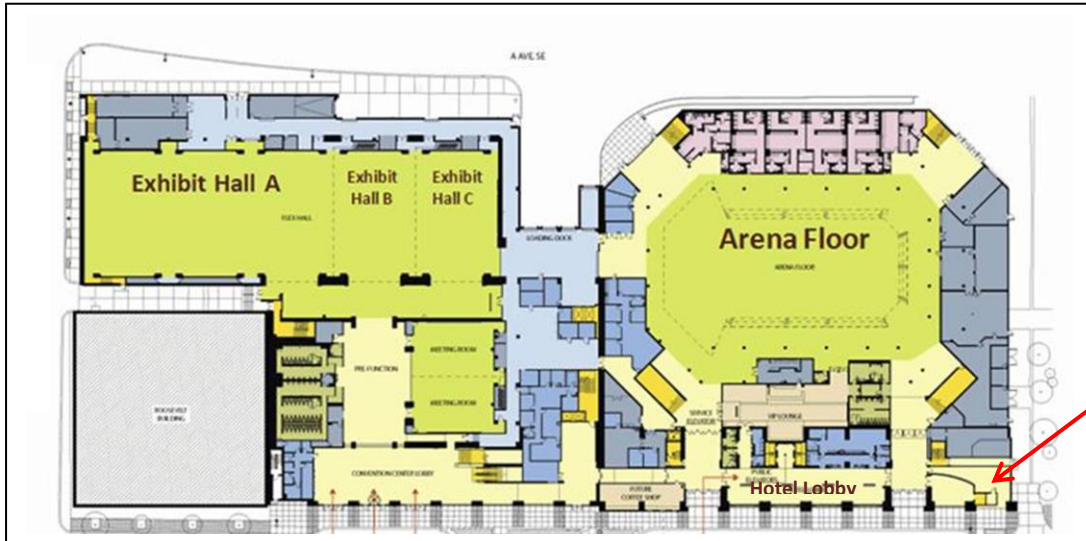

Both Parking Garages
attach to the
DoubleTree by Hilton
Cedar Rapids
Convention Complex
by way of Skywalk at
the indicated location: